



CROFTS ESTATE AGENTS

PASSIONATE ABOUT PROPERTY

CLEETHORPES
01472 200666

IMMINGHAM
01469 564294

LOUTH
01507 601550

SALES LETTINGS NEW HOME SALES LAND PROPERTY MANAGEMENT AUCTIONS FINANCIAL ADVICE AND MORTGAGES ENERGY PERFORMANCE PROVIDER



Epperstone Residential Caravan Park

Humberston
DN36 4HH

£20,000

CLEETHORPES: 62 St Peters Avenue, Cleethorpes, DN35 8HP

IMMINGHAM: 21 Kennedy Way, Immingham, DN40 2AB

LOUTH: 3 Market Place, Louth, LN11 9NR

Email: Cleethorpes:

Email: Immingham :

Email: Louth :

info@croftsestateagents.co.uk

immingham@croftsestateagents.co.uk

louth@croftsestateagents.co.uk

www.croftsestateagents.co.uk



Property Introduction

Affordable Park Home in the Heart of Humberston – 12-Month Residential Occupancy An excellent opportunity to own a well-presented park-style home located in the charming village of Humberston, conveniently positioned on the outskirts of Cleethorpes. This one-bedroom home features a comfortable lounge, kitchen, and a practical shower room. Benefitting from double glazing and LPG central heating, the property ensures year-round comfort. Set within a well-maintained residential site with 12-month occupancy, it also offers parking area. Perfect as a low-maintenance main residence or peaceful retreat.

Entrance Porch/Utility

3' 2" x 9' 7" (0.977m x 2.932m)

uPVC double glazed entry door to the side elevation. uPVC double glazed window to the front. Plumbing for a washing machine.

Kitchen

6' 5" x 7' 5" (1.948m x 2.261m)

The kitchen offers a range of wall and base units with contrasting work surfacing with inset stainless steel sink and drainer. Central heating radiator.

Lounge

8' 10" x 9' 3" (2.687m x 2.817m)

The lounge has uPVC double glazed French doors to the rear and windows to the side and front elevations. Two central heating radiators. Laminate flooring.

Shower Room

2' 7" x 7' 4" (0.792m x 2.231m)

uPVC double glazed window to the rear. Equipped with a close coupled combined toilet and washbasin. Shower cubicle. Central heating radiator. Tiling to the walls.

Bedroom

8' 11" x 7' 1" (2.725m x 2.151m)

With fitted wardrobes and having double glazed window. Central heating radiator.

Outside

A pleasant sized plot with patio and garden area to one side, pathway along the rear and detached garden store.

Tenure

Believed to be Leasehold, awaiting solicitors' formal confirmation.
All interested parties are advised to make their own enquiries.

Services

All mains services are understood to be connected, however Crofts have not inspected or tested any of the services or service installations & purchasers should rely on their own survey.

Broadband and Telecom Communications

Broadband and mobile speeds and availability can be assessed via the Ofcoms checker website.

<https://www.ofcom.org.uk/phones-and-broadband/coverage-and-speeds/ofcom-checker>

Viewings

Please contact the relevant marketing office, all viewings are strictly by appointment only please.

Council Tax Information

Band A: To confirm council tax banding for this property please view the website www.voa.gov.uk/cti

Free Valuations

We offer a free valuation with no obligation, just call the relevant office or visit www.croftsestateagents.co.uk seven days a week to arrange for your free valuation.

Property Management

We offer a full property management service, offering full and comprehensive credit and referencing checks detailed photographic inventories and regular property inspections to name just a few of our services.

Mortgage and Financial Advice

With access to a wide range of mortgages from over 50 of the UK's best-known lenders, **Crofts Estate Agents**, in partnership with **Forge Financial Solutions**, can help you find the mortgage that best suits your needs.

Forge Financial Solutions will act on your behalf, providing expert advice on mortgages and other financial matters, ensuring you receive tailored guidance and support throughout the process.

STATUTORY NOTICE: YOUR HOMES IS AT RISK IF YOU DO NOT KEEP UP REPAYMENTS ON A MORTGAGE OR OTHER LOAN SECURED ON IT.



GROUND FLOOR
22.0 sq.m. (237 sq.ft.) approx.

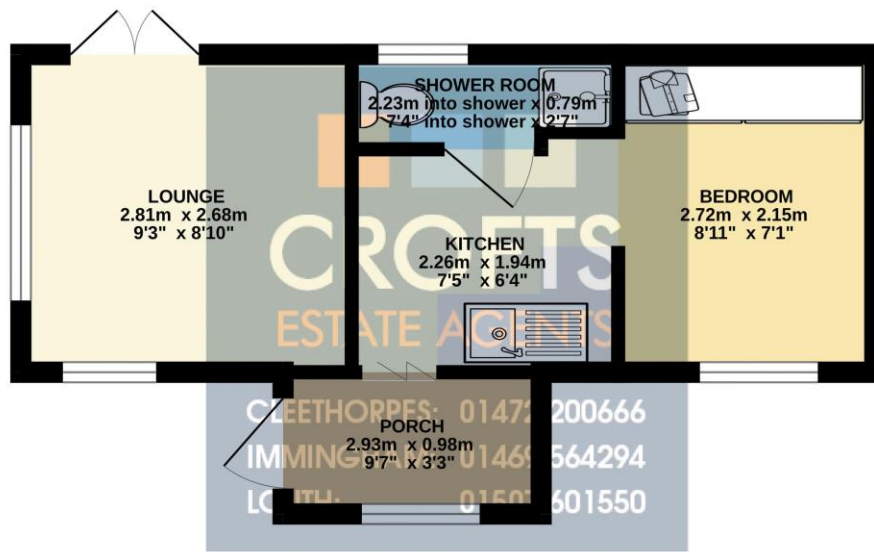

TOTAL FLOOR AREA: 22.0 sq.m. (237 sq.ft.) approx.

Whilst every attempt has been made to ensure the accuracy of the floorplan contained here, measurements of doors, windows, rooms and any other items are approximate and no responsibility is taken for any error, omission or mis-statement. This plan is for illustrative purposes only and should be used as such by any prospective purchaser. The services, systems and appliances shown have not been tested and no guarantee as to their operability or efficiency can be given.
Made with Metropix 12005